



122A-10-1/122A-40-1
Vaso bi-hexagonal de 1/2"



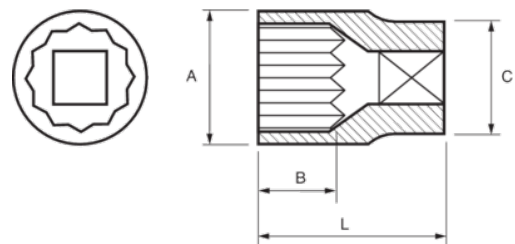

DETALLES DEL PRODUCTO

- Vasos de 1/2", bi-hexagonal, dimensiones en pulgadas.
- Aleación de acero al cromo vanadio.
- Acabado cromado brillante.
- Perfil NPP con forma ondulada.
- Normas: DIN3120 y DIN3124.



ATRIBUTOS DE PRODUCTO

Producto		A	B	C	L	
122A-12-1	3/8 in	15.5 mm	13 mm	22 mm	38 mm	45 g
122A-14-1	7/16 in	16.7 mm	13 mm	22 mm	38 mm	49 g
122A-16-1	1/2 in	19.2 mm	13 mm	22 mm	38 mm	54 g
122A-18-1	9/16 in	20.5 mm	13 mm	22 mm	38 mm	55 g
122A-20-1	5/8 in	22 mm	17.8 mm	20.6 mm	38 mm	69 g
122A-22-1	11/16 in	24 mm	17.8 mm	21.9 mm	38 mm	71 g
122A-24-1	3/4 in	26 mm	17.8 mm	22.9 mm	38 mm	75 g
122A-26-1	13/16 in	28 mm	17.8 mm	23.9 mm	38 mm	76 g
122A-28-1	7/8 in	30 mm	17.8 mm	26.1 mm	38 mm	88 g
122A-30-1	15/16 in	32 mm	17.8 mm	28.1 mm	38 mm	104 g
122A-34-1	1.1/16 in	36 mm	17.8 mm	30.1 mm	42 mm	141 g
122A-38-1	1.3/16 in	40 mm	17.8 mm	34.1 mm	44 mm	214 g
122A-40-1	1.1/4 in	42 mm	17.8 mm	36.1 mm	44 mm	233 g