



**132A-28-1/132A-64-1**

**Bocallaves bi-hexagonales de 3/4",  
pulgadas**



## DETALLES DEL PRODUCTO

- Bocallaves de 3/4", bi-hexagonales, dimensiones en pulgadas.
- Aleación de acero al cromo vanadio.
- Acabado cromado brillante.
- Perfil NPP con forma ondulada.
- Normas: DIN3120 y DIN3124.

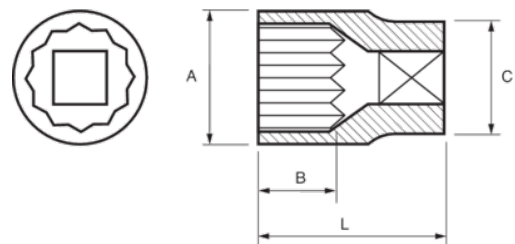

## ATRIBUTOS DE PRODUCTO

Producto		<b>A</b>	<b>B</b>	<b>C</b>	<b>L</b>	
<b>132A-28-1</b>	7/8 in	33 mm	12 mm	36 mm	50 mm	215 g
<b>132A-30-1</b>	15/16 in	35 mm	16 mm	36 mm	50 mm	215 g
<b>132A-32-1</b>	1 in	38 mm	16 mm	36 mm	52 mm	200 g
<b>132A-34-1</b>	1.1/16 in	38 mm	18 mm	36 mm	54 mm	240 g
<b>132A-36-1</b>	1.1/8 in	42 mm	18 mm	38 mm	55 mm	280 g
<b>132A-40-1</b>	1.1/4 in	44 mm	22 mm	38 mm	55 mm	310 g
<b>132A-42-1</b>	1.5/16 in	46 mm	22 mm	38 mm	57 mm	340 g
<b>132A-44-1</b>	1.3/8 in	48 mm	24 mm	42 mm	57 mm	380 g
<b>132A-46-1</b>	1.7/16 in	50 mm	24 mm	42 mm	57 mm	415 g
<b>132A-48-1</b>	1.1/2 in	52 mm	26 mm	44 mm	57 mm	455 g
<b>132A-52-1</b>	1.5/8 in	56 mm	27 mm	44 mm	63 mm	545 g
<b>132A-54-1</b>	1.11/16 in	58 mm	27 mm	44 mm	63 mm	600 g
<b>132A-60-1</b>	1.7/8 in	65 mm	30 mm	44 mm	68 mm	700 g
<b>132A-64-1</b>	2 in	68 mm	33 mm	44 mm	72 mm	755 g