

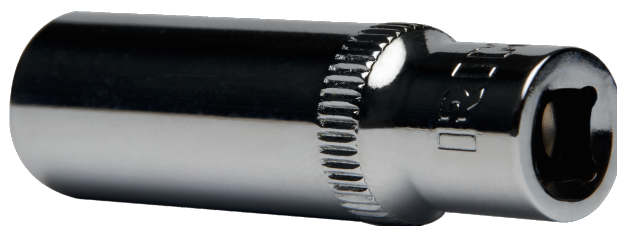

103A-12-1

Vaso hexagonal de serie larga de 1/4", 3/8"



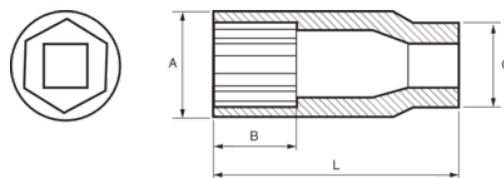

DETALLES DEL PRODUCTO

- Vasos serie larga de 1/4", hexagonales, dimensiones en pulgadas.
- Aleación de acero al cromo vanadio.
- Acabado cromado brillante.
- Perfil NPP con forma ondulada.
- Normas: DIN3120 y DIN3124.



ATRIBUTOS DE PRODUCTO

| Producto |  | A | B | C | L |  |
|------------------|---|----------|----------|----------|----------|---|
| 103A-12-1 | 3/8 in | 13.7 mm | 24 mm | 12 mm | 50 mm | 39 g |