



121-30-1

Vaso hexagonal de 1/2", 30 mm



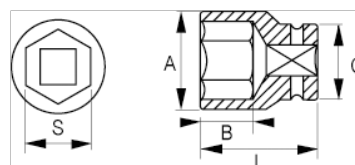

## DETALLES DEL PRODUCTO

- Vasos de 1/2", hexagonales, dimensiones en mm.
- Aleación de acero al cromo vanadio.
- Acabado cromado brillante.
- Perfil NPP con forma ondulada.
- Normas: DIN3120 y DIN3124.



## ATRIBUTOS DE PRODUCTO

| Producto        |  | <b>A</b> | <b>B</b> | <b>C</b> | <b>L</b> |  |
|-----------------|---|----------|----------|----------|----------|---|
| <b>121-30-1</b> | 30 mm   | 40 mm    | 17.8 mm  | 34.1 mm  | 44 mm    | 214 g   |