



103-04-1/103-14-1

1/4"-Sechskant-Steckschlüssel-Einsätze,
metrisch, lange Ausführung



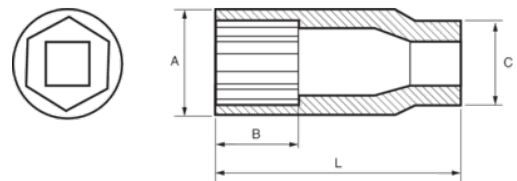

PRODUKTDDETAILS

- 1/4" Sechskant-Einsätze, metrisch, lange Ausführung
- Chrom-Vanadium-Stahllegierung
- Verchromt, hochglanzpoliert
- Wellenförmiges Spezialprofil Sechskant NPP
- Geprüft nach: DIN3120, DIN3124



PRODUKTEIGENSCHAFTEN

Produkt		A	B	C	L	
103-04-1	4 mm	6.9 mm	12 mm	12 mm	50 mm	21 g
103-045-1	4.5 mm	7.5 mm	12 mm	12 mm	50 mm	20 g
103-05-1	5 mm	8.2 mm	12 mm	12 mm	50 mm	21 g
103-055-1	5.5 mm	8.8 mm	12 mm	12 mm	50 mm	22 g
103-06-1	6 mm	9.4 mm	12 mm	12 mm	50 mm	22 g
103-07-1	7 mm	11 mm	24 mm	12 mm	50 mm	26 g
103-08-1	8 mm	12 mm	24 mm	10.9 mm	50 mm	29 g
103-09-1	9 mm	13 mm	24 mm	11.6 mm	50 mm	30 g
103-10-1	10 mm	14 mm	24 mm	13 mm	50 mm	39 g
103-11-1	11 mm	16 mm	24 mm	14.2 mm	50 mm	44 g
103-12-1	12 mm	17 mm	24 mm	15 mm	50 mm	49 g
103-13-1	13 mm	18 mm	24 mm	16 mm	50 mm	55 g
103-14-1	14 mm	20 mm	24 mm	17 mm	50 mm	65 g