



175-01-2/175-10-2  
3/4" Verlängerungen



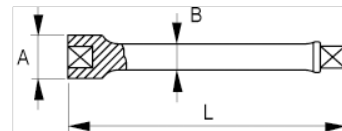

## PRODUKTDDETAILS

- 3/4" Verlängerungen
- Loch- und Haltering-System
- Chrom-Molybdän-Stahllegierung
- Phosphatiert
- Geprüft nach: UNE16503, ISO1174



PRODUKTEIGENSCHAFTEN

Produkt		<b>A</b>	<b>B</b>	<b>L</b>	
<b>175-01-2</b>		44 mm	21 mm	175 mm	850 g
<b>175-02-2</b>		44 mm	21 mm	325 mm	1460 g
<b>175-10-2</b>		44 mm	21 mm	250 mm	1190 g