



121-12-1

Vaso hexagonal de 1/2", 12 mm



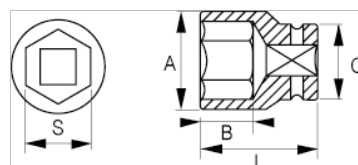

## DETALLES DEL PRODUCTO

- Vasos de 1/2", hexagonales, dimensiones en mm.
- Aleación de acero al cromo vanadio.
- Acabado cromado brillante.
- Perfil NPP con forma ondulada.
- Normas: DIN3120 y DIN3124.



## ATRIBUTOS DE PRODUCTO

| Producto        |  | <b>A</b> | <b>B</b> | <b>C</b> | <b>L</b> |  |
|-----------------|---|----------|----------|----------|----------|---|
| <b>121-12-1</b> | 12 mm   | 17.8 mm  | 13 mm    | 22 mm    | 38 mm    | 52 g  |