



7314-1/2

Tête de cliquet 1/2" 14x18 pour clé dynamométrique





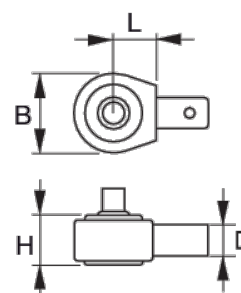

#### DÉTAILS SUR LE PRODUIT

- Reversible ratchet with 45 teeth/8° angle action
- Insert is fixed to the torque wrench by a spring loaded retractable pin
- High performance alloy steel



## ATTRIBUTS DU PRODUIT

Produit				<b>H</b>	<b>B</b>		
<b>7314-1/2</b>	1/2" mm	14x18 mm	420 N·m	20 mm	40 mm	25 mm	265 g