



105-46-1
Adaptor 1/4" to 3/8"



PRODUCT DETAILS

- Increasing adaptor from 1/4" to 3/8"
- Chrome vanadium alloy steel
- Chrome plated bright finish
- Standards: DIN 3120, DIN 3122

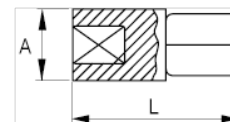

PRODUCT ATTRIBUTES

Product	A	L	g
105-46-1	12 mm	26 mm	31 g