



125-53-1
Spark Plug 1/2" Size 5/8"



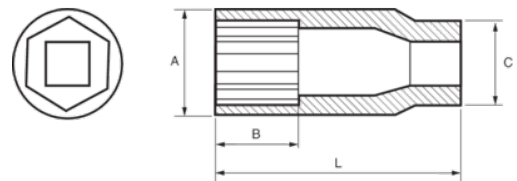

PRODUCT DETAILS

- 1/2" spark plug socket
- Spark plug socket used to fit or remove spark plugs from engines
- Hex profile
- Polished bright finish
- High performance CrV steel



PRODUCT ATTRIBUTES

Product			A	B	C	L	
125-53-1	16 mm	5/8 in	22 mm	32 mm	22 mm	65 mm	90 g