



**125-54-1**  
**Spark Plug 1/2" Size 13/16"**



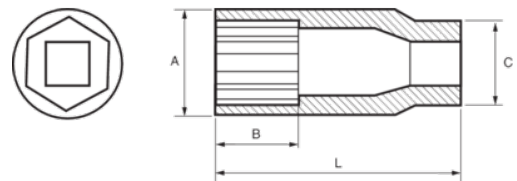

**PRODUCT DETAILS**

- 1/2" spark plug socket
- Spark plug socket used to fit or remove spark plugs from engines
- Hex profile
- Polished bright finish
- High performance CrV steel



PRODUCT ATTRIBUTES

Product			<b>A</b>	<b>B</b>	<b>C</b>	<b>L</b>	
<b>125-54-1</b>	21 mm	13/16" in	28 mm	31 mm	24 mm	65 mm	146 g