



132A-36-1

Socket 3/4" Bi-hex 1.1/8"



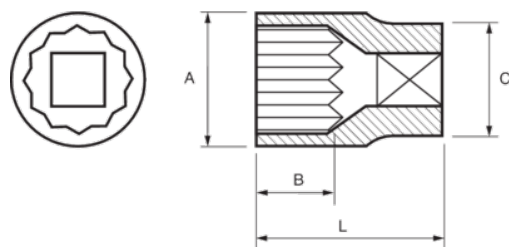

PRODUCT DETAILS

- 3/4" sockets, bi-hex, inch sizes
- Chrome vanadium alloy steel
- Chrome plated bright finish
- Wave shape profile NPP
- Standards: DIN 3120, DIN 3124



PRODUCT ATTRIBUTES

Product		A	B	C	L	
132A-36-1	1.1/8 in	42 mm	18 mm	38 mm	55 mm	280 g