



5-300-1

**Adjustable Wrench 12" Phosphated,
Clip**



PRODUCT DETAILS

- Jaw will not fall out even at maximum wrench opening
- Laser scale in mm for pre-adjusting and accurate measurement
- Parallel jaws at a 15° angle provide a firm grip and good reach
- High-performance alloy steel forged in a single piece
- Phosphate finish, precision hardened and anti-corrosion treated
- Standards: ISO 6787, DIN 3117, ASME B107.8-2003 and BS 6333
- - 1 retail packaging and -2 industrial packaging

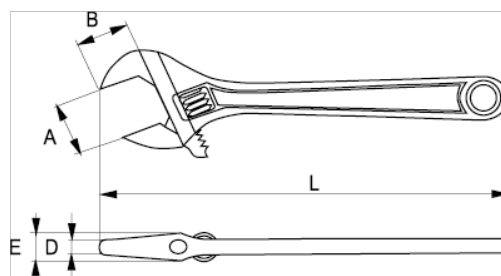

PRODUCT ATTRIBUTES

Product	L	L	A	B	D	E	
5-300-1	12 in	310 mm	36 mm	36 mm	11 mm	19 mm	650 g