



5-375-2

Adjustable Wrench 15" Phosphated



PRODUCT DETAILS

- Jaw will not fall out even at maximum wrench opening
- Laser scale in mm for pre-adjusting and accurate measurement
- Parallel jaws at a 15° angle provide a firm grip and good reach
- High-performance alloy steel forged in a single piece
- Phosphate finish, precision hardened and anti-corrosion treated
- Standards: ISO 6787, DIN 3117, ASME B107.8-2003 and BS 6333
- - 1 retail packaging and -2 industrial packaging

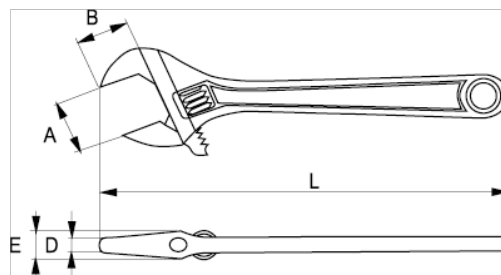

PRODUCT ATTRIBUTES

| Product | L | L | A | B | D | E |  g |
|----------------|----------|----------|----------|----------|----------|----------|--|
| 5-375-2 | 15 in | 385 mm | 43 mm | 45 mm | 13 mm | 24 mm | 1230 g |