



## 5-375C-2 Adjustable Wrench 15" Chromed



### PRODUCT DETAILS

- Jaw will not fall out even at maximum wrench opening
- Laser scale in mm for pre-adjusting and accurate measurement
- Parallel jaws at a 15° angle provide a firm grip and good reach
- High-performance alloy steel forged in a single piece
- Chrome plated finish, precision hardened and anti-corrosion treated
- Standards: ISO 6787, DIN 3117, ASME B107.8-2003 and BS 6333
- - 1 retail packaging and -2 industrial packaging

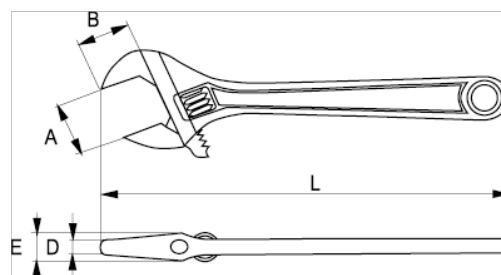

### PRODUCT ATTRIBUTES

Product	<b>L</b>	<b>L</b>	<b>A</b>	<b>B</b>	<b>D</b>	<b>E</b>	 <b>g</b>
<b>5-375C-2</b>	15 in	385 mm	43 mm	45 mm	13 mm	24 mm	1230 g