



7309-1/4

Head for Torque Wrench 1/4" 9x12
Ratchet





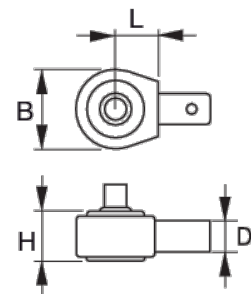

PRODUCT DETAILS

- Reversible ratchet with 45 teeth / 8° angle action
- Insert secured to torque wrench by spring loaded retractable pin
- High performance alloy steel

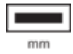

PRODUCT ATTRIBUTES

Product				H	B		
7309-1/4	1/4" mm	9x12 mm	25 N·m	20 mm	37 mm	18 mm	135 g