



515-003-1

Parallel Pin Punch Black Finish 3 mm



PRODUCT DETAILS

- Round shape
- Tip and shaft 52 HRC to 58 HRC
- Striking end 56 HRC to 58 HRC
- Chromium vanadium steel
- Standard: UNE 16575
- Black finished body
- Retail packaging

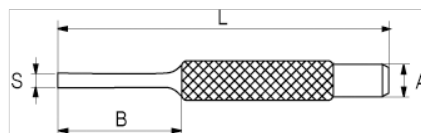

PRODUCT ATTRIBUTES

Product	S	L	A	B	
515-003-1	3 mm	100 mm	8 mm	28 mm	30 g