



515-008-1

Parallel Pin Punch Black Finish 8 mm



### PRODUCT DETAILS

- Round shape
- Tip and shaft 52 HRC to 58 HRC
- Striking end 56 HRC to 58 HRC
- Chromium vanadium steel
- Standard: UNE 16575
- Black finished body
- Retail packaging

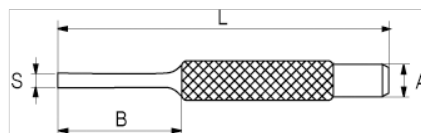

### PRODUCT ATTRIBUTES

Product	<b>S</b>	<b>L</b>	<b>A</b>	<b>B</b>	
<b>515-008-1</b>	8 mm	130 mm	12 mm	43 mm	91 g