



**167-23-1**

**Impact Socket 1/2" Hex 23 mm**



## PRODUCT DETAILS

- 1/2" impact sockets
- High performance Cr-Mo alloy steel
- Phosphate finish
- To be used with machines
- To be used with retaining ring
- Dynamic-Drive profile to protect nuts
- Standards: UNE 16507, DIN 3129, ISO 2725

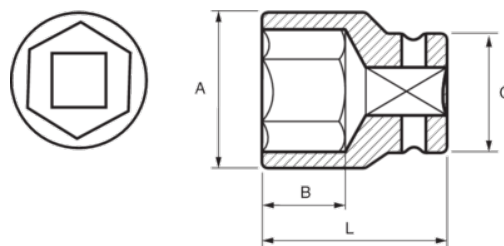

PRODUCT ATTRIBUTES

| Product         |  | <b>A</b> | <b>B</b> | <b>C</b> | <b>L</b> |  |
|-----------------|---|----------|----------|----------|----------|---|
| <b>167-23-1</b> | 23 mm   | 34 mm    | 18 mm    | 30 mm    | 40 mm    | 149 g   |