



169-65-1

1/2" to 3/8" Impact Decreasing Adaptor



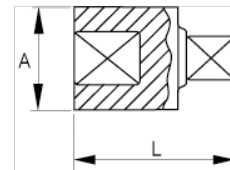

PRODUCT DETAILS

- 1/2" to 3/8" impact reducing adaptor
- High performance Cr-Mo alloy steel
- Phosphate finish
- To be used with machines
- To be used with retaining ring
- Standards: UNE 16507, DIN 3129, ISO 2725



PRODUCT ATTRIBUTES

Product			A	L	
169-65-1	1/2 in	3/8 in	25 mm	38 mm	129 g