



179-65-2

## 1" to 3/4" Impact Decreasing Adaptor



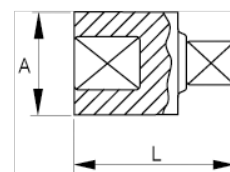

### PRODUCT DETAILS

- Impact reducing adaptor 1" to 3/4"
- High performance Cr-Mo alloy steel
- Phosphate finish
- To be used with machines
- To be used with retaining ring
- Due to the special working conditions of this adaptor, it is not guaranteed against male failure
- Standards: UNE 16507, DIN 3129, ISO 2725



## PRODUCT ATTRIBUTES

Product			<b>A</b>	<b>L</b>	
<b>179-65-2</b>	1 in	3/4 in	54 mm	70 mm	350 g