



124A-18-1

Socket 1/2" Deep Bi-hex 9/16"



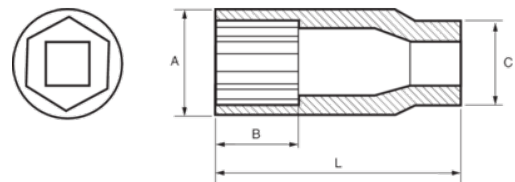

## PRODUCT DETAILS

- 1/2" deep sockets, bi-hex, inch sizes
- Chrome vanadium alloy steel
- Chrome plated bright finish
- Wave shape profile NPP
- Standards: DIN 3120, DIN 3124



PRODUCT ATTRIBUTES

Product		<b>A</b>	<b>B</b>	<b>C</b>	<b>L</b>	
<b>124A-18-1</b>	9/16 in	22 mm	31 mm	22 mm	78 mm	113 g