



161-10-1/161-17-1

3/8" Impact Sockets Hex Deep  
Metric



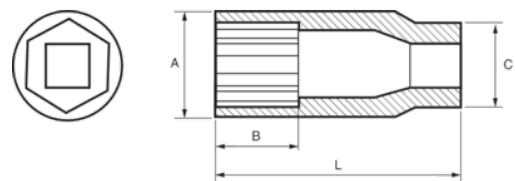

## PRODUCT DETAILS

- 3/8" impact sockets, deep, metric sizes
- High performance Cr-Mo alloy steel
- Phosphate finish
- To be used with machines
- To be used with retaining ring
- Dynamic-Drive profile to protect nuts
- Standards: UNE 16507, DIN 3129, ISO 2725



PRODUCT ATTRIBUTES

| Product         |  | <b>A</b> | <b>B</b> | <b>C</b> | <b>L</b> |  |
|-----------------|---|----------|----------|----------|----------|---|
| <b>161-10-1</b> | 10 mm   | 15.9 mm  | 10 mm    | 19 mm    | 63 mm    | 77 g  |
| <b>161-13-1</b> | 13 mm   | 19.7 mm  | 10 mm    | 19 mm    | 63 mm    | 96 g  |
| <b>161-17-1</b> | 17 mm   | 24.5 mm  | 11 mm    | 22 mm    | 63 mm    | 184 g   |