



162-65-1

3/8" to 1/4" Impact Reducing Adaptors



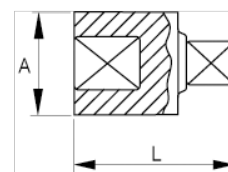

PRODUCT DETAILS

- 3/8" to 1/4" impact reducing adaptor
- High performance Cr-Mo alloy steel
- Phosphate finish
- To be used with machines
- To be used with retaining ring
- Due to the special working conditions of this adaptor, it is not guaranteed against male failure
- Standards: UNE 16503, DIN 3129, ISO 1174



PRODUCT ATTRIBUTES

Product			A	L	
162-65-1	1/4 in	3/8 in	19 mm	28 mm	57 g