



175-65-2

### 3/4" to 1/2" Impact Reducing Adaptors



#### PRODUCT DETAILS

- 3/4" to 1/2" impact reducing adaptor
- High performance Cr-Mo alloy steel
- Phosphate finish
- To be used with machines
- To be used with retaining ring
- Due to the special working conditions of this adaptor, it is not guaranteed against male failure
- Standards: UNE 16507, DIN 3129, ISO 2725

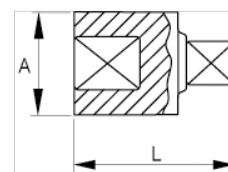

PRODUCT ATTRIBUTES

Product			A	L	
175-65-2	1/2"	3/4"	44 mm	57 mm	350 g