

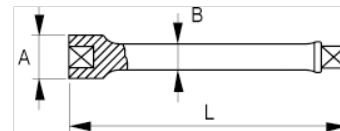



179-00-2/179-02-2
1" Impact Extensions

PRODUCT DETAILS

- 1" impact extensions
- High performance Cr-Mo alloy steel
- Phosphate finish
- To be used with machines
- To be used with retaining ring
- Standards: UNE 16507, DIN 3129, ISO 2725



PRODUCT ATTRIBUTES

Product		A	B	L	 g
179-00-2	1 in	54 mm	34 mm	125 mm	1085 g
179-01-2		54 mm	34 mm	175 mm	1390 g
179-02-2		54 mm	34 mm	325 mm	2395 g