



515

Pin Punches Parallel Knurled Rounded



PRODUCT DETAILS

- Round shape
- Tip and shaft 52 HRC to 58 HRC
- Striking end 56 HRC to 58 HRC
- Chromium vanadium steel
- Standard: UNE 16575
- Black finished body
- Retail packaging

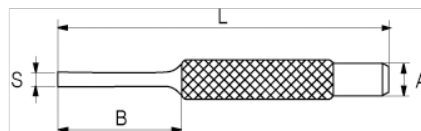

PRODUCT ATTRIBUTES

Product	S	L	A	B	 g
515-002-1	2 mm	100 mm	8 mm	28 mm	29 g
515-003-1	3 mm	100 mm	8 mm	28 mm	30 g
515-004-1	4 mm	100 mm	8 mm	28 mm	31 g
515-005-1	5 mm	115 mm	10 mm	33 mm	53 g
515-006-1	6 mm	115 mm	10 mm	33 mm	55 g
515-007-1	7 mm	115 mm	10 mm	33 mm	58 g
515-008-1	8 mm	130 mm	12 mm	43 mm	91 g
515-009-1	9 mm	130 mm	12 mm	43 mm	96 g
515-010-1	10 mm	130 mm	14 mm	53 mm	143 g