



7314-1/2

Head for Torque Wrench 1/2" 14x18
Ratchet





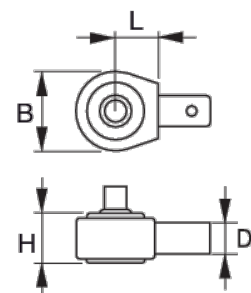

PRODUCT DETAILS

- Reversible ratchet with 45 teeth / 8° angle action
- Insert secured to torque wrench by spring loaded retractable pin
- High performance alloy steel

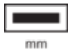

PRODUCT ATTRIBUTES

Product				H	B		
7314-1/2	1/2" mm	14x18 mm	420 N·m	20 mm	40 mm	25 mm	265 g