



121-12-1

Socket 1/2" Hex 12 mm



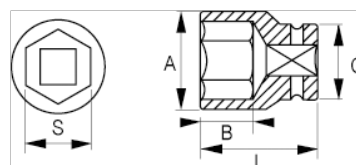

PRODUCT DETAILS

- 1/2" Sockets, Hex, sizes in mm
- Chrome vanadium alloy steel
- Chrome-plated bright finish
- Wave shape profile NPP
- Standards: DIN3120, DIN3124



PRODUCT ATTRIBUTES

Product		A	B	C	L	
121-12-1	12 mm	17.8 mm	13 mm	22 mm	38 mm	52 g