



101-08-1

Chiave a bussola 1/4" esagonale 8 mm



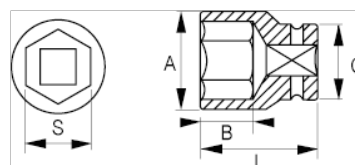

DETTAGLI PRODOTTO

- Chiave a bussola 1/4", esagonali, in millimetri
- Acciaio legato al cromo-vanadio
- Finitura lucida cromata
- Profilo ondulato NPP
- Conforme alle norme: DIN3120, DIN3124



ATTRIBUTI PRODOTTO

Prodotto		A	B	C	L	
101-08-1	8 mm	12 mm	12 mm	12 mm	25 mm	13 g