



101-10-1

Chiave a bussola 1/4" esagonale 10 mm



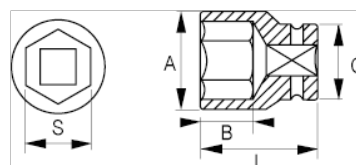

DETTAGLI PRODOTTO

- Chiave a bussola 1/4", esagonali, in millimetri
- Acciaio legato al cromo-vanadio
- Finitura lucida cromata
- Profilo ondulato NPP
- Conforme alle norme: DIN3120, DIN3124



ATTRIBUTI PRODOTTO

Prodotto		A	B	C	L	
101-10-1	10 mm	14 mm	12 mm	12.6 mm	25 mm	21 g