



101A-07-1

Chiave a bussola 1/4" esagonale
7/32"



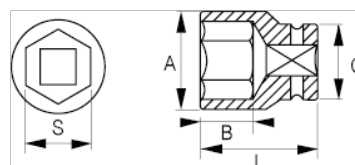

DETTAGLI PRODOTTO

- Chiave a bussola 1/4", esagonale, in pollici
- Acciaio legato al cromo-vanadio
- Finitura lucida cromata
- Profilo ondulato NPP
- Conforme alle norme: DIN3120, DIN3124



ATTRIBUTI PRODOTTO

| Prodotto |  | A | B | C | L |  |
|------------------|---|----------|----------|----------|----------|---|
| 101A-07-1 | 7/32 in | 8.8 mm | 9.5 mm | 12 mm | 25 mm | 11 g |