



101A-08-1

Chiave a bussola 1/4" esagonale 1/4"



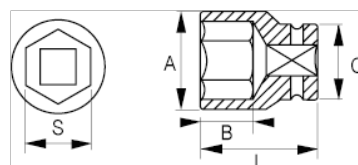

DETTAGLI PRODOTTO

- Chiave a bussola 1/4", esagonale, in pollici
- Acciaio legato al cromo-vanadio
- Finitura lucida cromata
- Profilo ondulato NPP
- Conforme alle norme: DIN3120, DIN3124



ATTRIBUTI PRODOTTO

Prodotto		A	B	C	L	
101A-08-1	1/4 in	9.4 mm	9.5 mm	12 mm	25 mm	11 g