



101A-09-1

**Chiave a bussola 1/4" esagonale
9/32"**



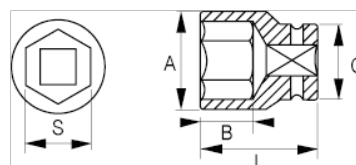

DETTAGLI PRODOTTO

- Chiave a bussola 1/4", esagonale, in pollici
- Acciaio legato al cromo-vanadio
- Finitura lucida cromata
- Profilo ondulato NPP
- Conforme alle norme: DIN3120, DIN3124



ATTRIBUTI PRODOTTO

Prodotto		A	B	C	L	
101A-09-1	9/32 in	11 mm	10.5 mm	12 mm	25 mm	13 g