



101A-14-1

**Chiave a bussola 1/4" esagonale
7/16"**



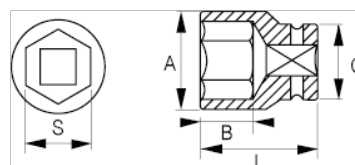

DETTAGLI PRODOTTO

- Chiave a bussola 1/4", esagonale, in pollici
- Acciaio legato al cromo-vanadio
- Finitura lucida cromata
- Profilo ondulato NPP
- Conforme alle norme: DIN3120, DIN3124



ATTRIBUTI PRODOTTO

Prodotto		A	B	C	L	
101A-14-1	7/16 in	16 mm	11.5 mm	14 mm	25 mm	23 g