



112-09-1

Chiave a bussola 3/8" esagonale 9 mm



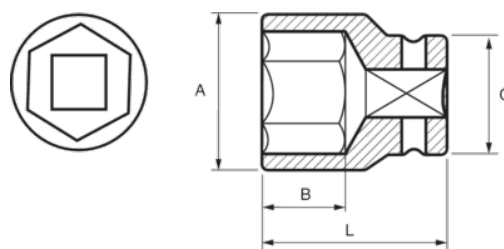

DETTAGLI PRODOTTO

- Chiave a bussola esagonali 3/8", in millimetri
- Acciaio legato al cromo-vanadio
- Finitura lucida cromata
- Profilo ondulato NPP
- Conforme alle norme: DIN3120, DIN3124



ATTRIBUTI PRODOTTO

Prodotto		A	B	C	L	
112-09-1	9 mm	13.5 mm	9 mm	17 mm	28 mm	26 g