



7309-1/4

Inserto a cricchetto per chiave  
dinamometrica 1/4", 9X12





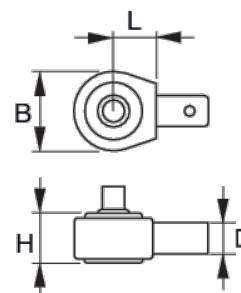

#### DETTAGLI PRODOTTO

- Cricchetto reversibile con 45 denti/avanzamento  $8^\circ$
- L'inserto è fissato alla chiave dinamometrica con uno spinotto retrattile caricato a molla
- Acciaio legato ad alte prestazioni



## ATTRIBUTI PRODOTTO

Prodotto				<b>H</b>	<b>B</b>		
<b>7309-1/4</b>	1/4" mm	9x12 mm	25 N·m	20 mm	37 mm	18 mm	135 g