



7309-3/8

Inserto a cricchetto per chiave
dinamometrica 9x12, 3/8"





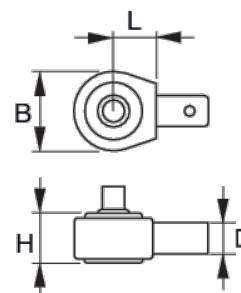

DETTAGLI PRODOTTO

- Cricchetto reversibile con 45 denti/avanzamento 8°
- L'inserto è fissato alla chiave dinamometrica con uno spinotto retrattile caricato a molla
- Acciaio legato ad alte prestazioni



ATTRIBUTI PRODOTTO

Prodotto				H	B		
7309-3/8	3/8" mm	9x12 mm	160 N·m	20 mm	38 mm	18 mm	160 g