



103A-16-1

Chiave a bussola 1/4" serie lunga
esagonale 1/2"



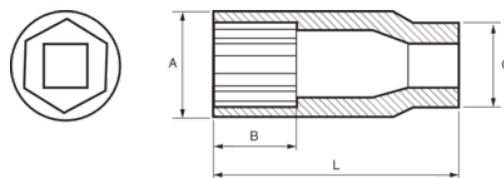

DETTAGLI PRODOTTO

- Chiave a bussola serie lunga 1/4", esagonale, in pollici
- Acciaio legato al cromo-vanadio
- Finitura lucida cromata
- Profilo ondulato NPP
- Conforme alle norme: DIN3120, DIN3124



ATTRIBUTI PRODOTTO

Prodotto		A	B	C	L	
103A-16-1	1/2 in	18 mm	24 mm	16 mm	50 mm	55 g