



**101A-05-1/101A-18-1**

**Chiave a bussola esagonale 1/4", in pollici**



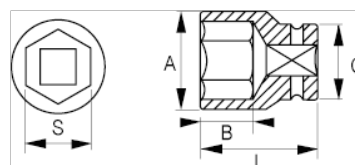

## DETTAGLI PRODOTTO

- Chiave a bussola 1/4", esagonale, in pollici
- Acciaio legato al cromo-vanadio
- Finitura lucida cromata
- Profilo ondulato NPP
- Conforme alle norme: DIN3120, DIN3124



## ATTRIBUTI PRODOTTO

Prodotto		<b>A</b>	<b>B</b>	<b>C</b>	<b>L</b>	
<b>101A-05-1</b>	5/32 in	6.9 mm	8.5 mm	12 mm	25 mm	10 g
<b>101A-06-1</b>	3/16 in	7.5 mm	8.5 mm	12 mm	25 mm	10 g
<b>101A-07-1</b>	7/32 in	8.8 mm	9.5 mm	12 mm	25 mm	11 g
<b>101A-08-1</b>	1/4 in	9.4 mm	9.5 mm	12 mm	25 mm	11 g
<b>101A-09-1</b>	9/32 in	11 mm	10.5 mm	12 mm	25 mm	13 g
<b>101A-10-1</b>	5/16 in	12 mm	10.5 mm	12 mm	25 mm	12 g
<b>101A-11-1</b>	11/32 in	13 mm	10.5 mm	12 mm	25 mm	14 g
<b>101A-12-1</b>	3/8 in	14 mm	10.5 mm	12.6 mm	25 mm	18 g
<b>101A-14-1</b>	7/16 in	16 mm	11.5 mm	14 mm	25 mm	23 g
<b>101A-16-1</b>	1/2 in	18 mm	11.5 mm	15.8 mm	25 mm	29 g
<b>101A-18-1</b>	9/16 in	20 mm	11.5 mm	17.4 mm	25 mm	37 g