



131-19-1/131-60-1

Chiave a bussola esagonale 3/4", in
millimetri



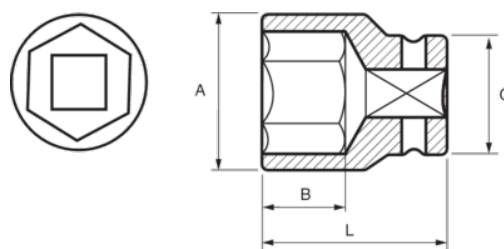

DETTAGLI PRODOTTO

- Chiave a bussola 3/4", esagonale, in millimetri
- Acciaio legato al cromo-vanadio
- Finitura lucida cromata
- Profilo ondulato NPP
- Conforme alle norme: DIN3120, DIN3124



ATTRIBUTI PRODOTTO

Prodotto		A	B	C	L	
131-19-1	19 mm	30 mm	12 mm	36 mm	50 mm	200 g
131-21-1		32 mm	12 mm	36 mm	50 mm	215 g
131-22-1	22 mm	33 mm	12 mm	36 mm	50 mm	215 g
131-23-1	23 mm	34 mm	14 mm	36 mm	50 mm	215 g
131-24-1	24 mm	34 mm	16 mm	36 mm	50 mm	215 g
131-25-1	25 mm	38 mm	16 mm	36 mm	50 mm	220 g
131-26-1	26 mm	38 mm	16 mm	36 mm	52 mm	220 g
131-27-1	27 mm	38 mm	18 mm	36 mm	52 mm	240 g
131-28-1	28 mm	38 mm	18 mm	36 mm	52 mm	250 g
131-29-1	29 mm	42 mm	18 mm	38 mm	52 mm	260 g
131-30-1	30 mm	42 mm	20 mm	38 mm	52 mm	275 g
131-32-1	32 mm	44 mm	22 mm	38 mm	52 mm	310 g
131-33-1	33 mm	46 mm	22 mm	38 mm	55 mm	340 g
131-34-1	34 mm	46 mm	22 mm	38 mm	57 mm	330 g
131-35-1	35 mm	48 mm	24 mm	42 mm	57 mm	380 g
131-36-1	36 mm	50 mm	24 mm	42 mm	57 mm	415 g
131-38-1	38 mm	52 mm	26 mm	44 mm	57 mm	455 g
131-40-1	40 mm	56 mm	27 mm	44 mm	63 mm	505 g
131-41-1		56 mm	27 mm	44 mm	63 mm	545 g
131-42-1		58 mm	27 mm	44 mm	63 mm	600 g
131-46-1		62 mm	30 mm	44 mm	68 mm	650 g
131-50-1		68 mm	33 mm	44 mm	72 mm	755 g
131-55-1		75 mm	36 mm	48 mm	75 mm	1000 g
131-60-1		80 mm	39 mm	48 mm	77 mm	1100 g