



7314-1/2

Inserto a cricchetto per chiave  
dinamometrica 1/2", 14x18





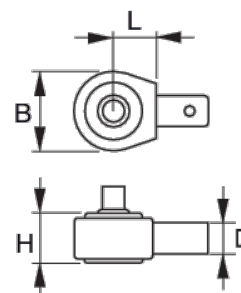

## DETTAGLI PRODOTTO

- Cricchetto reversibile con 45 denti/avanzamento  $8^\circ$
- L'inserto è fissato alla chiave dinamometrica con uno spinotto retrattile caricato a molla
- Acciaio legato ad alte prestazioni

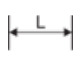

## ATTRIBUTI PRODOTTO

Prodotto				<b>H</b>	<b>B</b>		
<b>7314-1/2</b>	1/2" mm	14x18 mm	420 N·m	20 mm	40 mm	25 mm	265 g