



121-21-1

Chiave a bussola 1/2" esagonale 21 mm



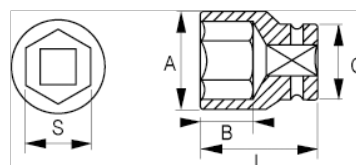

DETTAGLI PRODOTTO

- Chiave a bussola esagonale 1/2", in millimetri
- Acciaio legato al cromo-vanadio
- Finitura lucida cromata
- Profilo ondulato NPP
- Conforme alle norme: DIN3120, DIN3124



ATTRIBUTI PRODOTTO

Prodotto		A	B	C	L	
121-21-1	21 mm	28 mm	17.8 mm	23.9 mm	38 mm	95 g