



**121-24-1**

**Chiave a bussola 1/2" esagonale 24 mm**



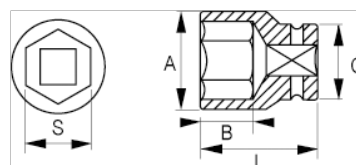

## DETTAGLI PRODOTTO

- Chiave a bussola esagonale 1/2", in millimetri
- Acciaio legato al cromo-vanadio
- Finitura lucida cromata
- Profilo ondulato NPP
- Conforme alle norme: DIN3120, DIN3124



## ATTRIBUTI PRODOTTO

Prodotto		<b>A</b>	<b>B</b>	<b>C</b>	<b>L</b>	
<b>121-24-1</b>	24 mm	32 mm	17.8 mm	28.1 mm	38 mm	109 g