



177-22-2/177-80-2

Dados de impacto hexagonales de 1",
mm



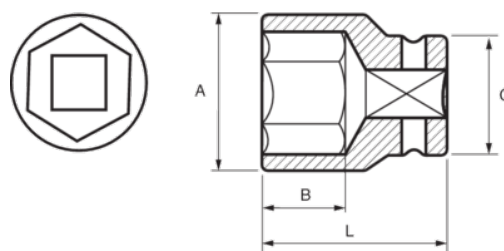

DETALLES DEL PRODUCTO

- Dados de impacto de 1".
- Aleación de acero de cromo molibdeno de alto rendimiento.
- Acabado fosfatado.
- Para usar con máquinas.
- Para usar con muelle de seguridad.
- Perfil Dynamic-Drive para proteger las tuercas.
- Normas: UNE16507, DIN 3129 e ISO 2725.



ATRIBUTOS DE PRODUCTO

| Producto |  | A | B | C | L |  |
|-----------------|---|----------|----------|----------|----------|---|
| 177-22-2 | 22 mm | 39 mm | 22 mm | 54 mm | 58 mm | 645 g |
| 177-24-2 | 24 mm | 41 mm | 22 mm | 54 mm | 58 mm | 650 g |
| 177-27-2 | 27 mm | 46 mm | 22 mm | 54 mm | 58 mm | 670 g |
| 177-30-2 | 30 mm | 49 mm | 24 mm | 54 mm | 62 mm | 680 g |
| 177-32-2 | 32 mm | 52 mm | 24 mm | 54 mm | 62 mm | 695 g |
| 177-33-2 | 33 mm | 54 mm | 24 mm | 54 mm | 62 mm | 695 g |
| 177-34-2 | 34 mm | 54 mm | 24 mm | 54 mm | 62 mm | 720 g |
| 177-36-2 | 36 mm | 56 mm | 29 mm | 54 mm | 65 mm | 800 g |
| 177-38-2 | 38 mm | 58 mm | 29 mm | 54 mm | 65 mm | 845 g |
| 177-41-2 | 41 mm | 61 mm | 34 mm | 54 mm | 70 mm | 920 g |
| 177-42-2 | 42 mm | 64 mm | 34 mm | 54 mm | 70 mm | 950 g |
| 177-46-2 | 46 mm | 68 mm | 36 mm | 54 mm | 75 mm | 1150 g |
| 177-50-2 | 50 mm | 75 mm | 36 mm | 54 mm | 83 mm | 1375 g |
| 177-55-2 | 55 mm | 79 mm | 44 mm | 54 mm | 83 mm | 1540 g |
| 177-60-2 | 60 mm | 86 mm | 47 mm | 54 mm | 87 mm | 1700 g |
| 177-65-2 | 65 mm | 92 mm | 47 mm | 54 mm | 90 mm | 1940 g |
| 177-70-2 | 70 mm | 97 mm | 47 mm | 54 mm | 93 mm | 3540 g |
| 177-75-2 | 75 mm | 104 mm | 47 mm | 86 mm | 95 mm | 2900 g |
| 177-80-2 | 80 mm | 110 mm | 39 mm | 86 mm | 100 mm | 3300 g |