



121-09-1

Dado hexagonal de 1/2", 9 mm



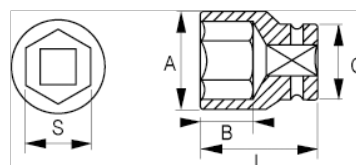

DETALLES DEL PRODUCTO

- Dados de 1/2", hexagonales, dimensiones en mm.
- Aleación de acero al cromo vanadio.
- Acabado cromado brillante.
- Perfil NPP con forma ondulada.
- Normas: DIN3120 y DIN3124.



ATRIBUTOS DE PRODUCTO

| Producto |  | A | B | C | L |  |
|-----------------|---|----------|----------|----------|----------|---|
| 121-09-1 | 9 mm | 15.3 mm | 13 mm | 22 mm | 38 mm | 48 g |