



202441

Par de mandíbulas com parafusos
para torno de bancada
207041,216041



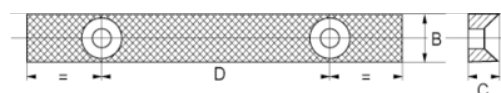

DETALHES DO PRODUTO

- Par de mandíbulas e parafusos sobresselentes para tornos de bancada quadrados 207041/207071 e 216

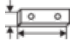

ATRIBUTOS DO PRODUTO

Produto		B	C	D	
202441	100 mm	15 mm	10 mm	64 mm	350 g