



T4901

Adaptador 1/2" para pontas de 10 mm





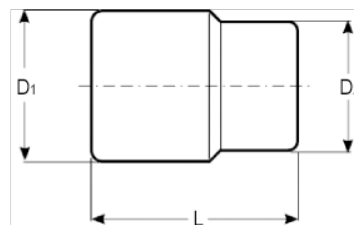

DETALHES DO PRODUTO

- Adaptador de chaves quadradas 1/2" para pontas de 10 mm
- Acabamento polido de alta qualidade
- Liga de aço de alto desempenho
- Normas: ISO 1174, DIN 3120



ATRIBUTOS DO PRODUTO

Produto				D1	D2	L	
T4901	1	10 mm	1/2 in	17 mm	22 mm	36 mm	55 g