



7309-1/4

Cabeça para chave dinamométrica  
1/4" 9X12 com roquete





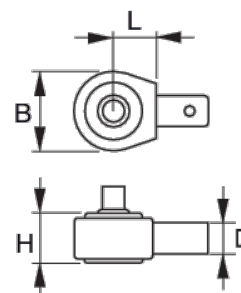

#### DETALHES DO PRODUTO

- Roquete reversível com 45 dentes/8° de ação angular
- A inserção é fixada à chave dinamométrica por um pino retrátil com mola
- Liga de aço de alto desempenho

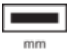

## ATRIBUTOS DO PRODUTO

Produto				<b>H</b>	<b>B</b>		
<b>7309-1/4</b>	1/4" mm	9x12 mm	25 N·m	20 mm	37 mm	18 mm	135 g