



7309-3/8

**Cabeça para chave dinamométrica
3/8" 9X12 com roquete**





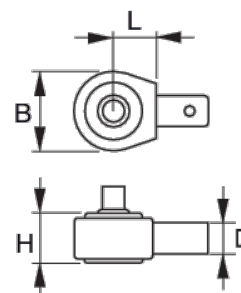

DETALHES DO PRODUTO

- Roquete reversível com 45 dentes/8° de ação angular
- A inserção é fixada à chave dinamométrica por um pino retrátil com mola
- Liga de aço de alto desempenho

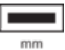

ATRIBUTOS DO PRODUTO

Produto				H	B		
7309-3/8	3/8" mm	9x12 mm	160 N·m	20 mm	38 mm	18 mm	160 g